

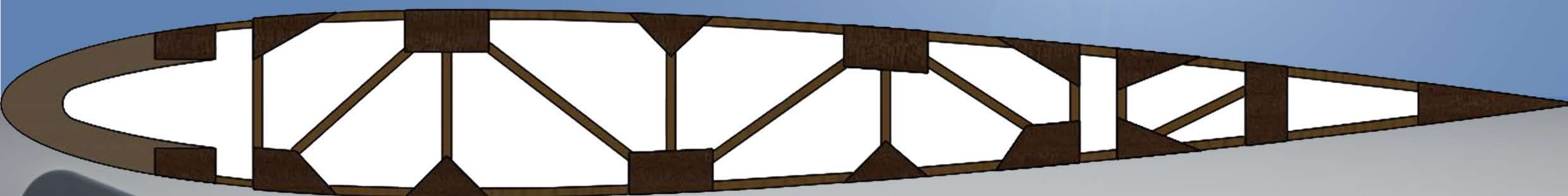

# *RARA-AVIS SIMS*



*'ENGLISH ELECTRIC'*

*Wren*

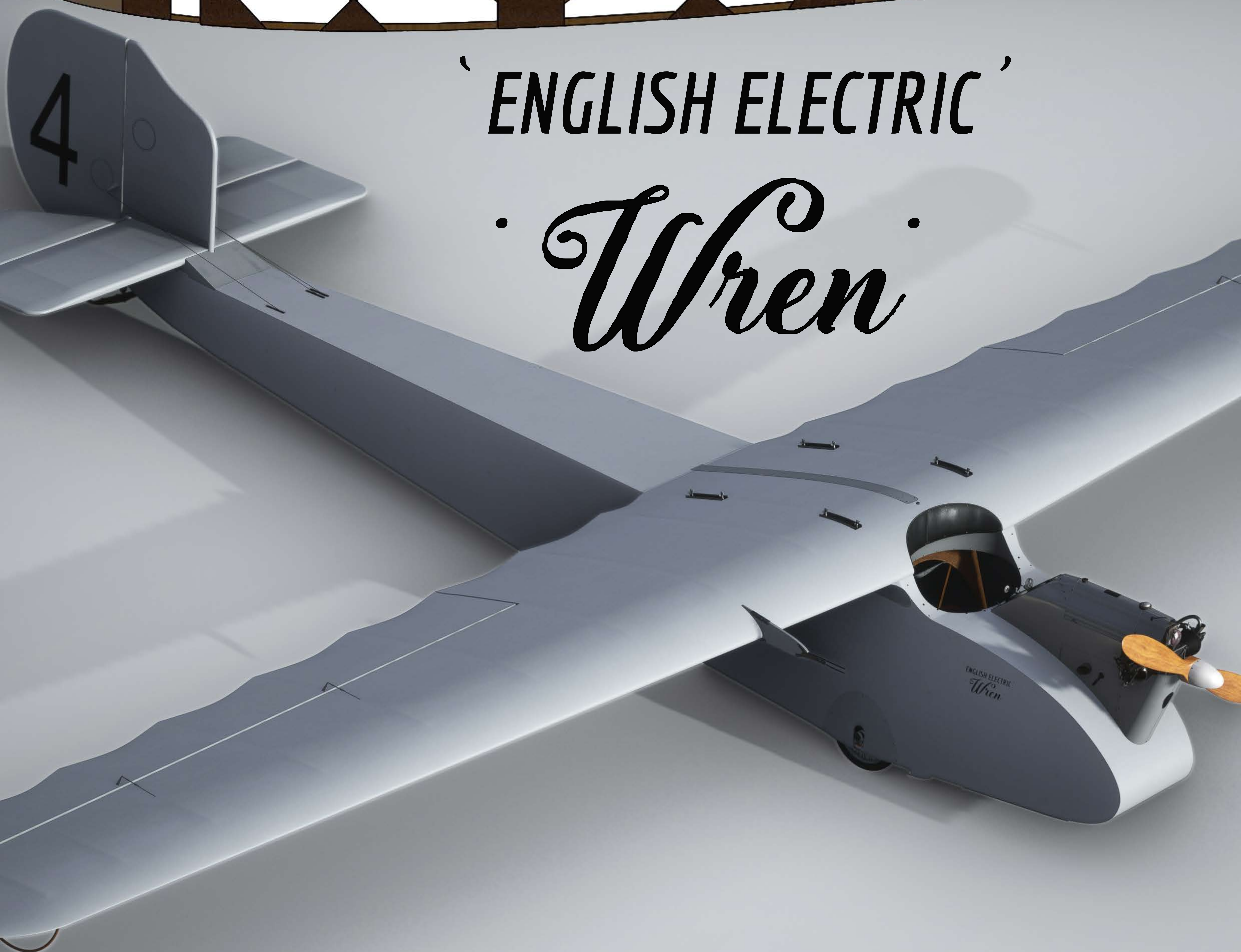

Microsoft *Flight Simulator*







# *RARA-AVIS SIMS*



## Introduction

Rara Avis means 'Rare Bird' in Latin. The name was chosen because many of the subjects are less well known, but still appealing vintage subjects.

Rara-Avis Sims brings you high quality models which can be purchased for your use in Microsoft Flight Simulator.

Please make sure you have chosen your launch method before clicking the "FLY" button as it will default to "Winch launch" \*

It is recommended that the "Flight model" be set to "Modern" in the options menu to give the best flight dynamics.

The "Legacy flight model" should only be used for FSX port overs.

To add or remove the Pilot use the weight screen from within the sim.

\* To start the winch process just wiggle the rudder while on the runway, too much of a steep ascent while winching will cause an overspeed.

<https://raraavissims.wixsite.com/rara-avis-sims>





# *RARA-AVIS SIMS*

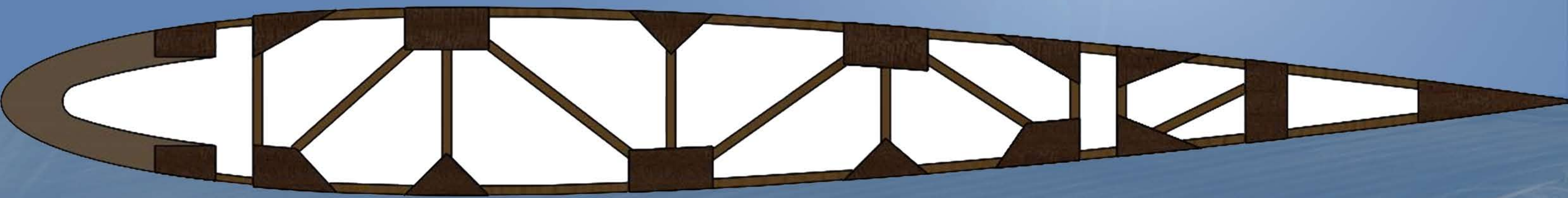

## Important Information

### Disclaimer & End User Licence Agreement

This product is intended for entertainment purposes only and should not be used for real world flight training.

No replication, reverse engineering of this software, either in whole or in part, is permitted in ANY form without the express written permission of Rara-Avis Sims. Any enquiries regarding commercial, military or academic use of this software should be directed to [rara-avis\\_sim@outlook.com](mailto:rara-avis_sim@outlook.com)

By installing this software, you are hereby agreeing to the above terms and conditions.

### About this guide

This guide has been written to familiarise new users to the operations of the English Electric Wren.

It is highly recommended that users have a working knowledge of Microsoft Flight Simulator.





# *RARA-AVIS SIMS*

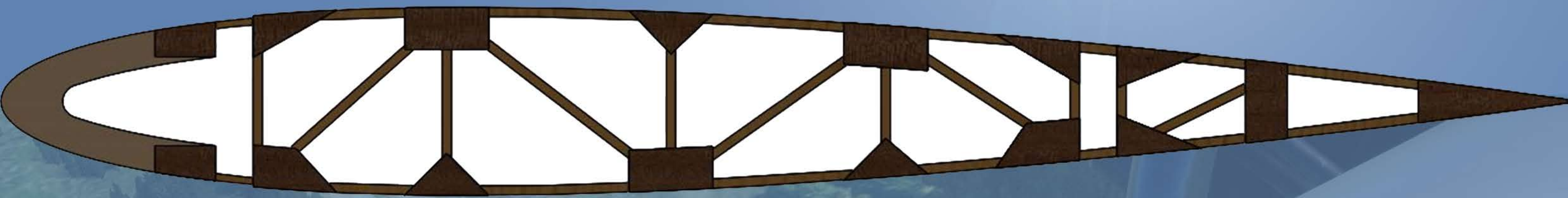

## Specifications

### General characteristics

Crew: One

Length: 24 ft 3 in (7.39 m)

Wingspan: 37 ft 0 in (11.28 m)

Height: 4 ft 9 in (1.45 m)

Wing area: 145 sq ft (13.5 m<sup>2</sup>)

Empty weight: 232 lb (105 kg)

Gross weight: 420 lb (191 kg)

Powerplant: ABC 8 hp 2-cylinder air-cooled piston engine

### Performance

Maximum speed: 50 mph (80 km/h, 43 kts)

Rate of climb: 180 ft/min (0.91 m/s)

Range: 87.5 miles





# *RARA-AVIS SIMS*



## Product Features

- 4K PBR textures.
- 3D propeller blur.
- Hidden GPS and Radio stack
- Uses stock MSFS pilots.
- Custom 3D gauges.
- Custom sounds from the real aircraft.
- Custom camera positions.
- Custom dirt\grime\livery decals.
- Custom engine animations.
- Twelve paints (Nine fictional, but in keeping with the era).
- 3D models built from scratch.
- Accurate interior modelling (Access to the real plane, Shuttleworth Collection).
- Main gear and tail skid bungee animations.
- FX - Tyre dust.
- Custom bump mapping of wing ribs and internal structure.
- Propeller click starter.
- Oil pulsator (visual only).
- Custom checklists.
- Full VR support.
- 100 Years old (October 1923).
- Animated control cables (internal & external).
- Three launch methods (Tow, winch, and standard take-off).
- Animated clipboard with "pilots notes"
- Pocket compass with pitch and roll animations.





# *RARA-AVIS SIMS*

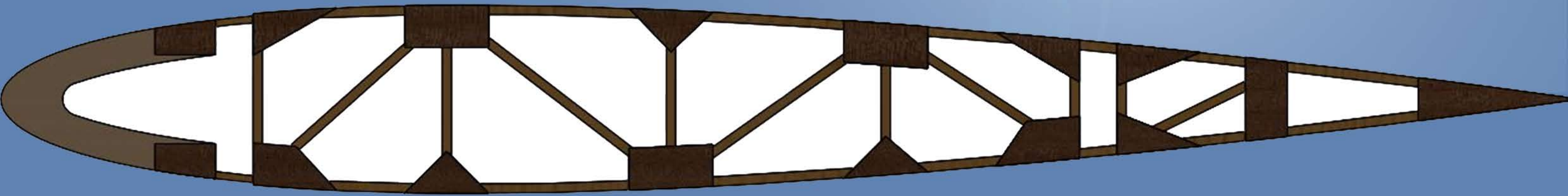

## Cockpit Orientation Section 1

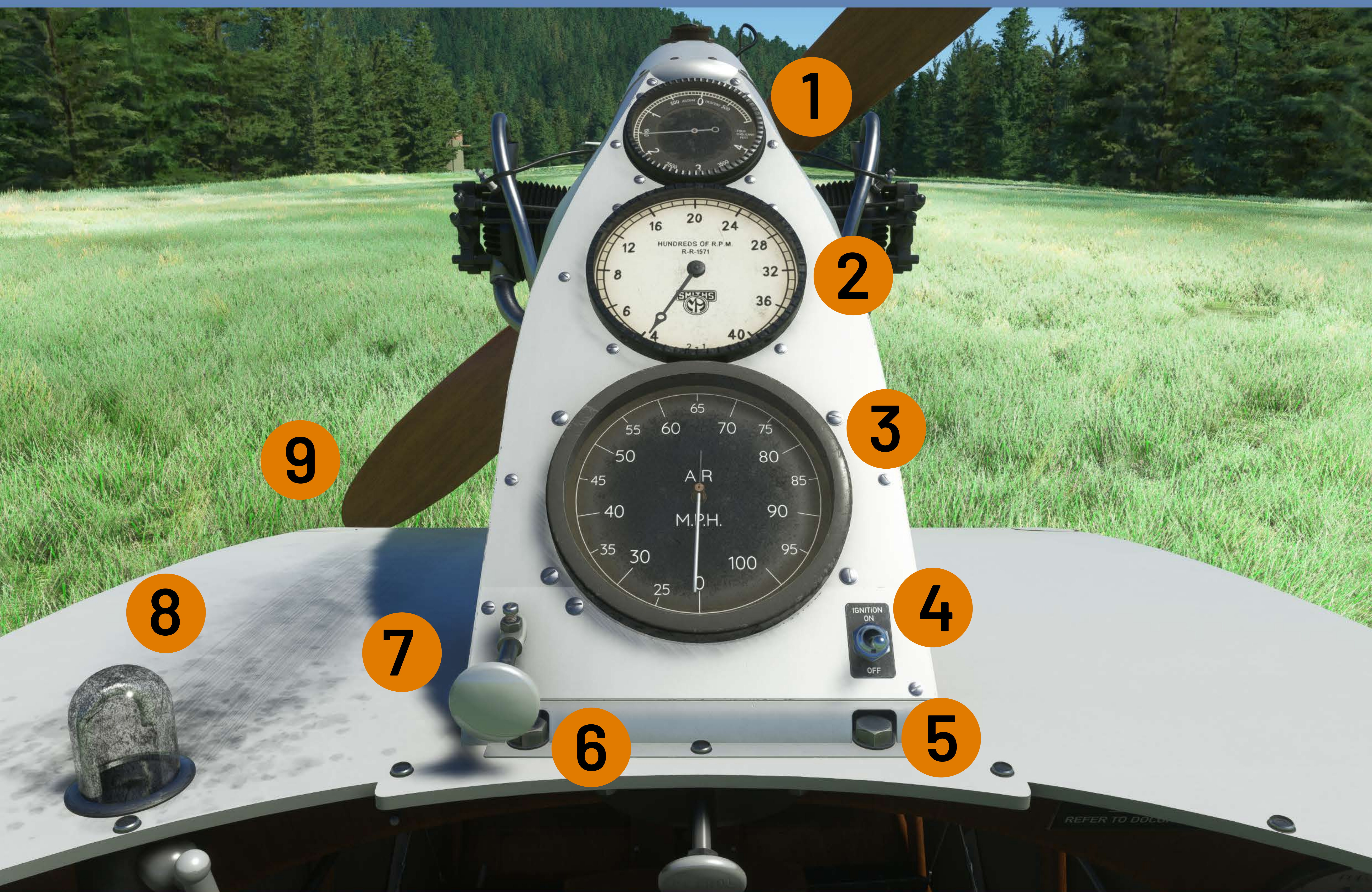

- |                        |                                |                               |
|------------------------|--------------------------------|-------------------------------|
| 1 - Altimeter          | 5 - GPS Switch (Right Nut)     | 9 - Engine Starter (Prop Tip) |
| 2 - RPM Indicator      | 6 - Radio Switch (Left Nut)    |                               |
| 3 - Airspeed Indicator | 7 - Throttle                   |                               |
| 4 - Ignition Switch    | 8 - Oil Pulsator (visual only) |                               |





# *RARA-AVIS SIMS*

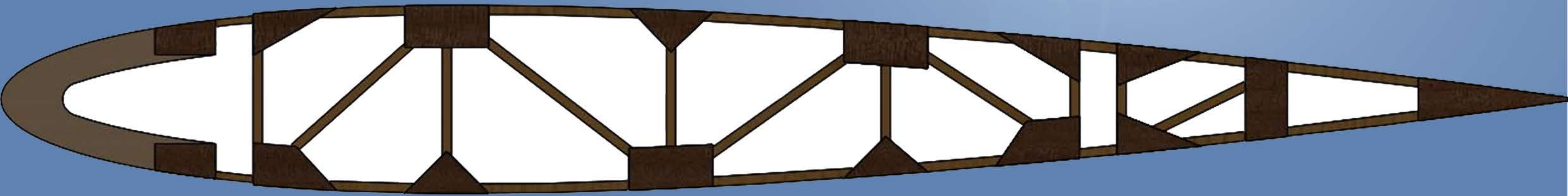

## Cockpit Orientation Section 2

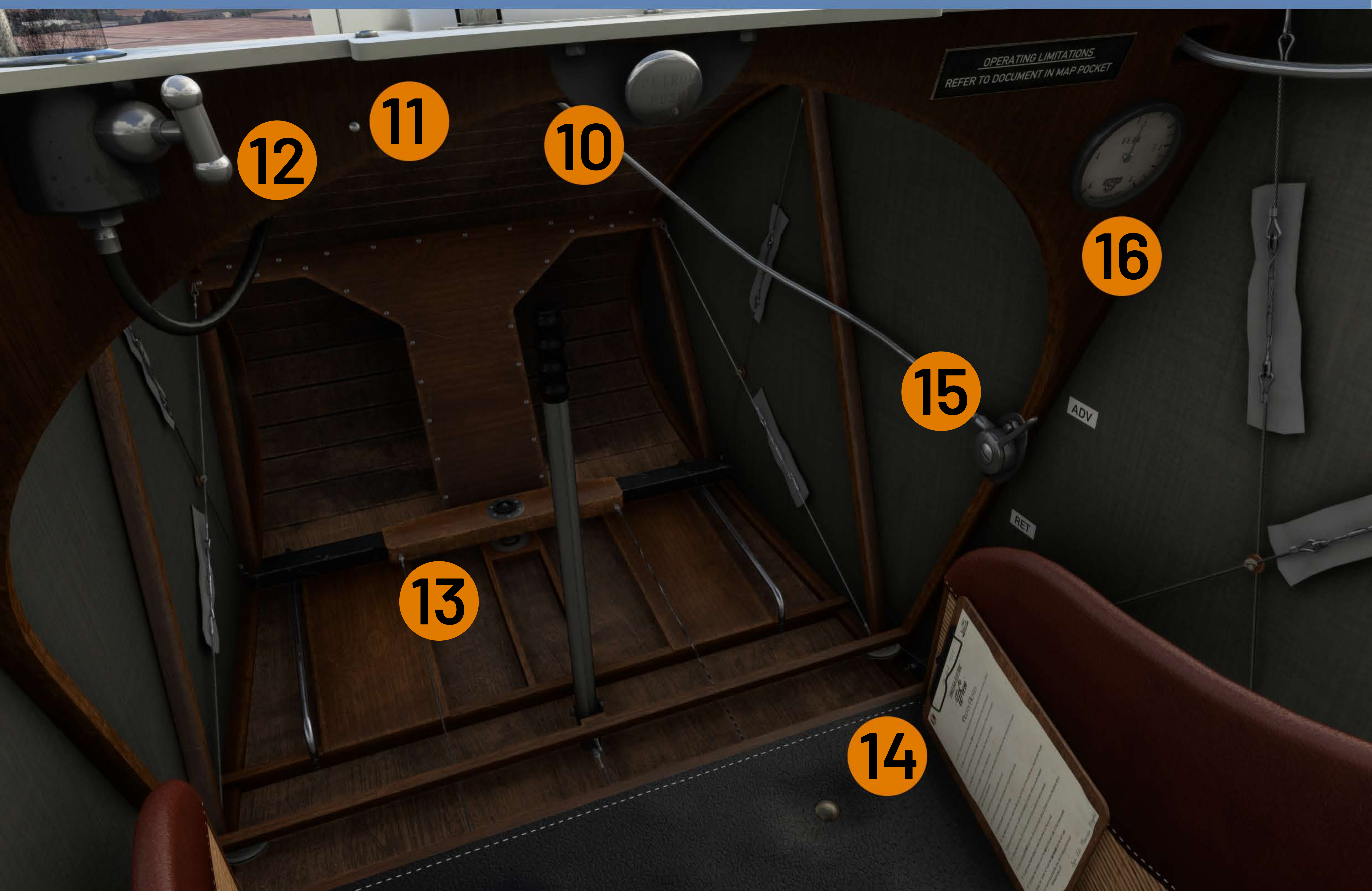

- |                            |                    |
|----------------------------|--------------------|
| 10 - Fuel Cut Off          | 14 - Clipboard     |
| 11 - Compass Switch (Nail) | 15 - Choke/Mixture |
| 12 - Winter Kit            | 16 - Fuel Gauge    |
| 13 - Parking Brake         |                    |



# RARA-AVIS SIMS



## Cockpit Orientation Section 3



- 17 - Transponder
- 18 - Clock
- 19 - Communications Radio
- 20 - Battery Switch



# The Fleet

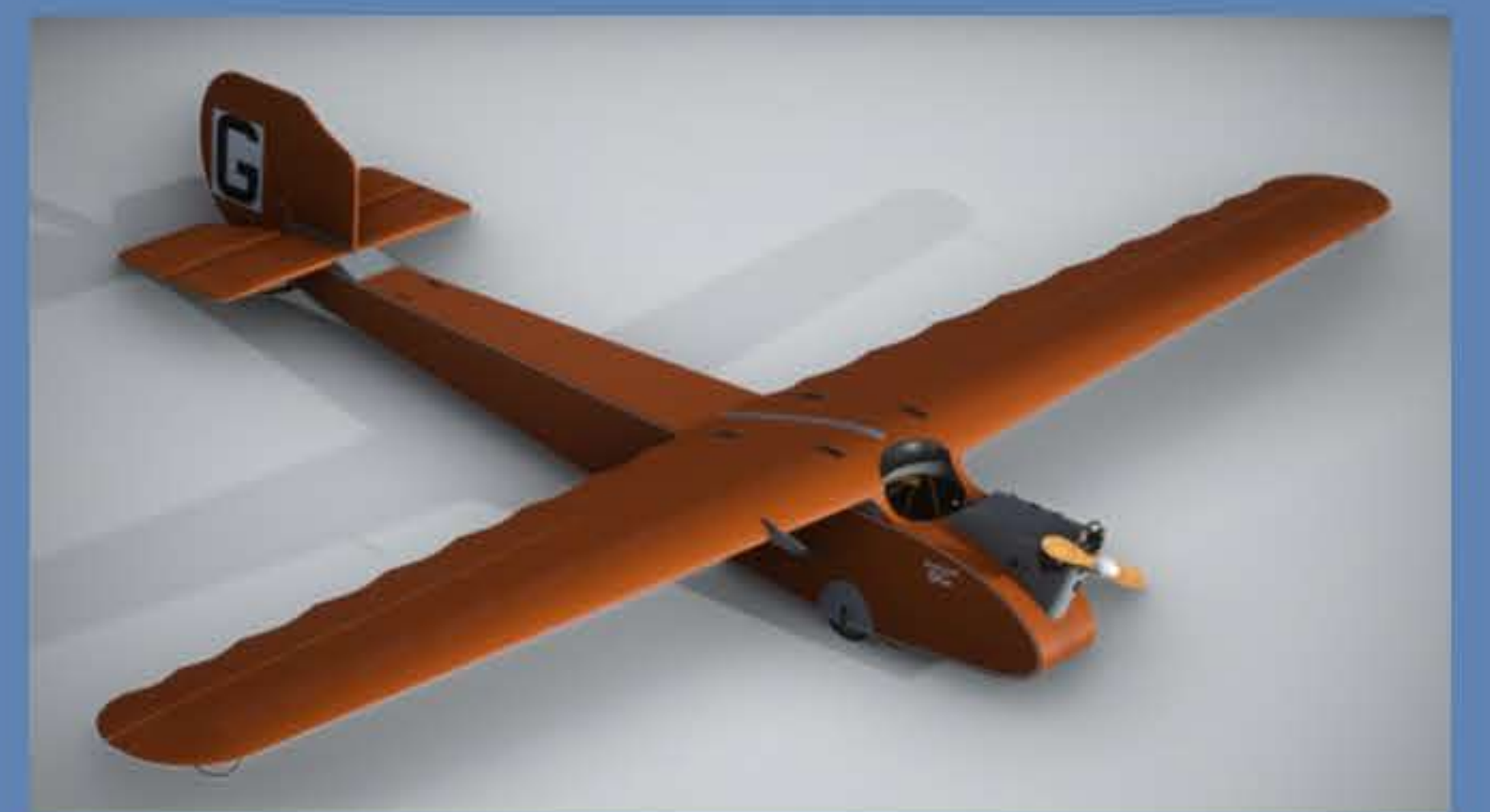
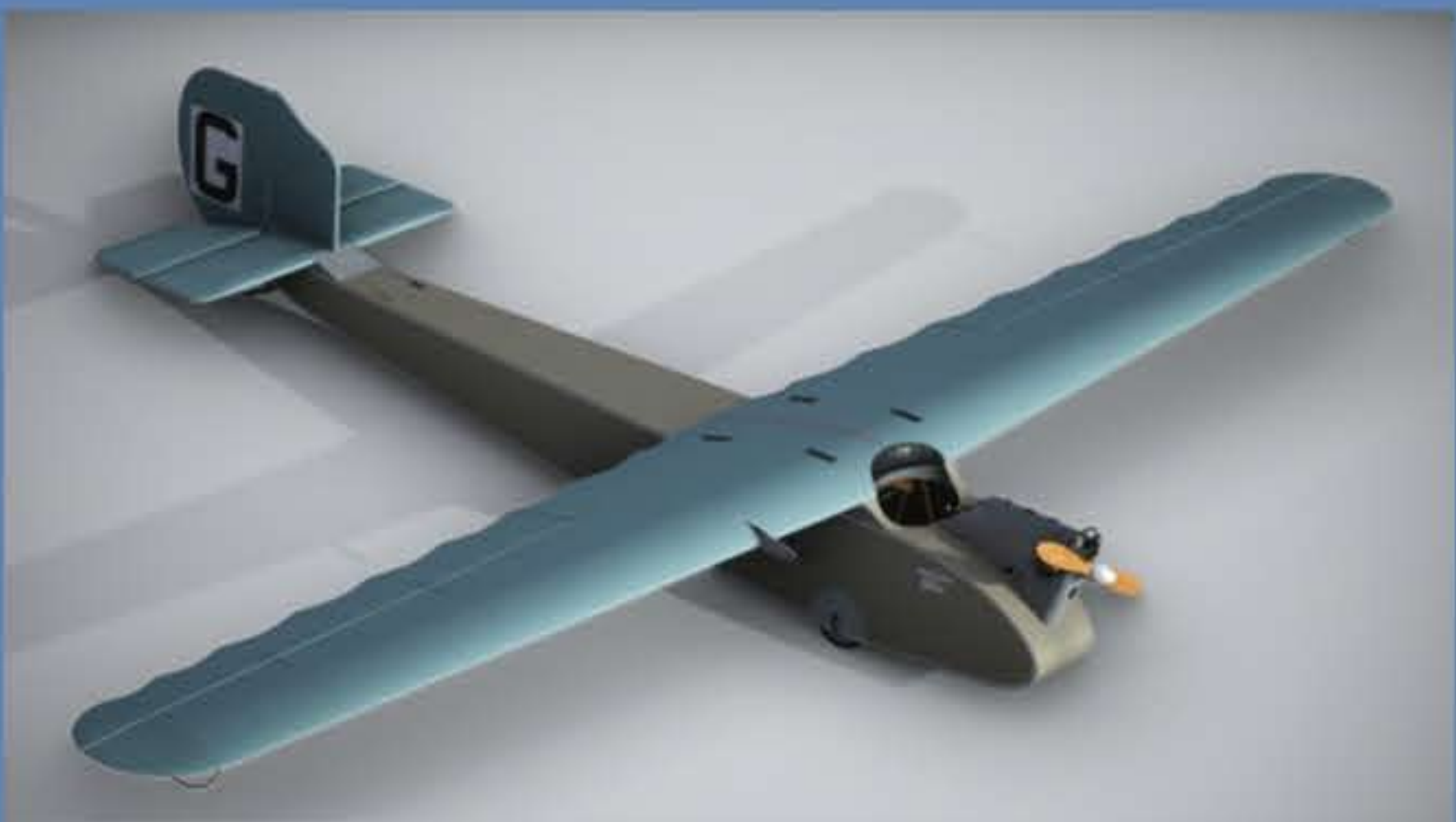
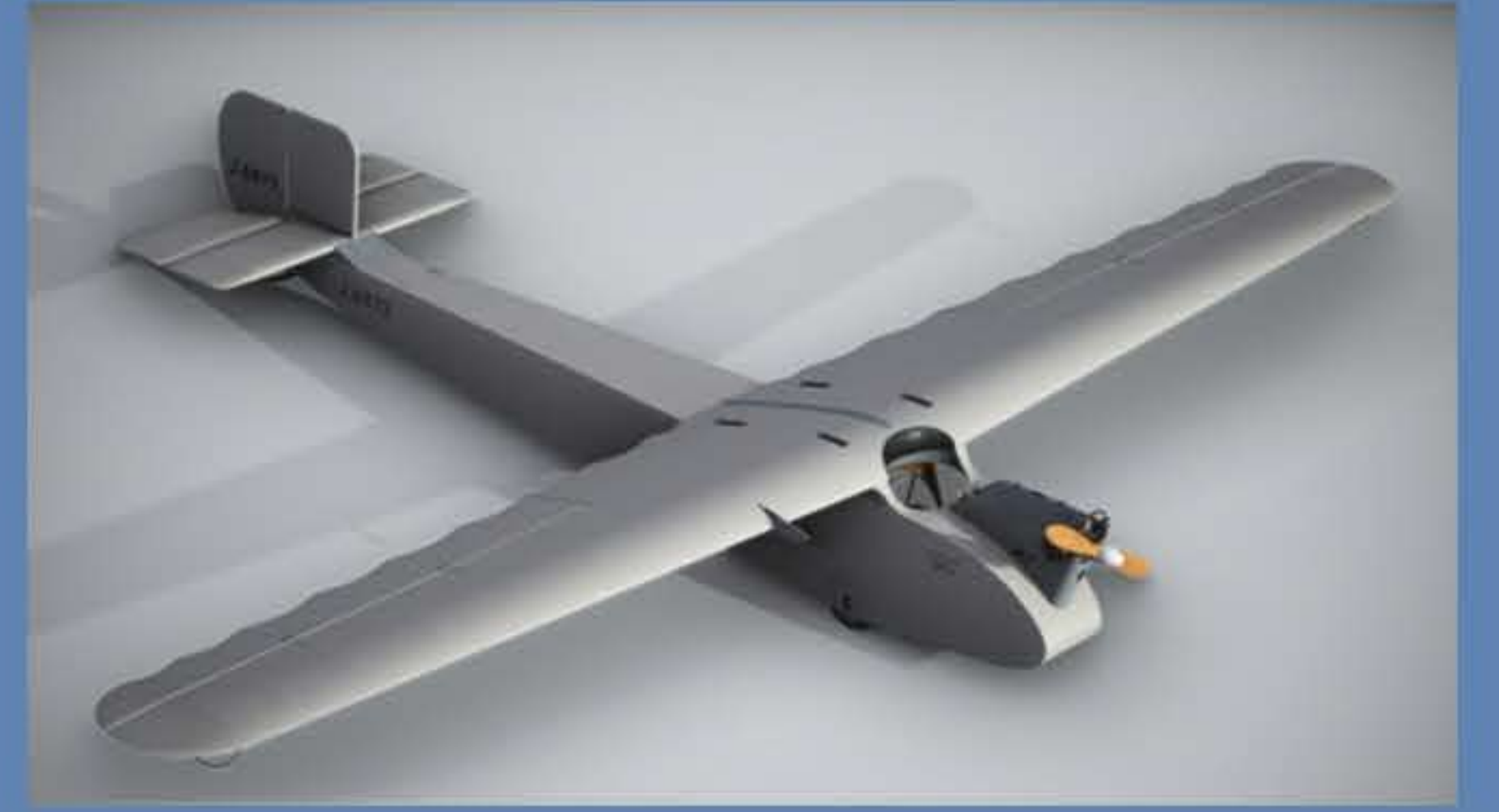
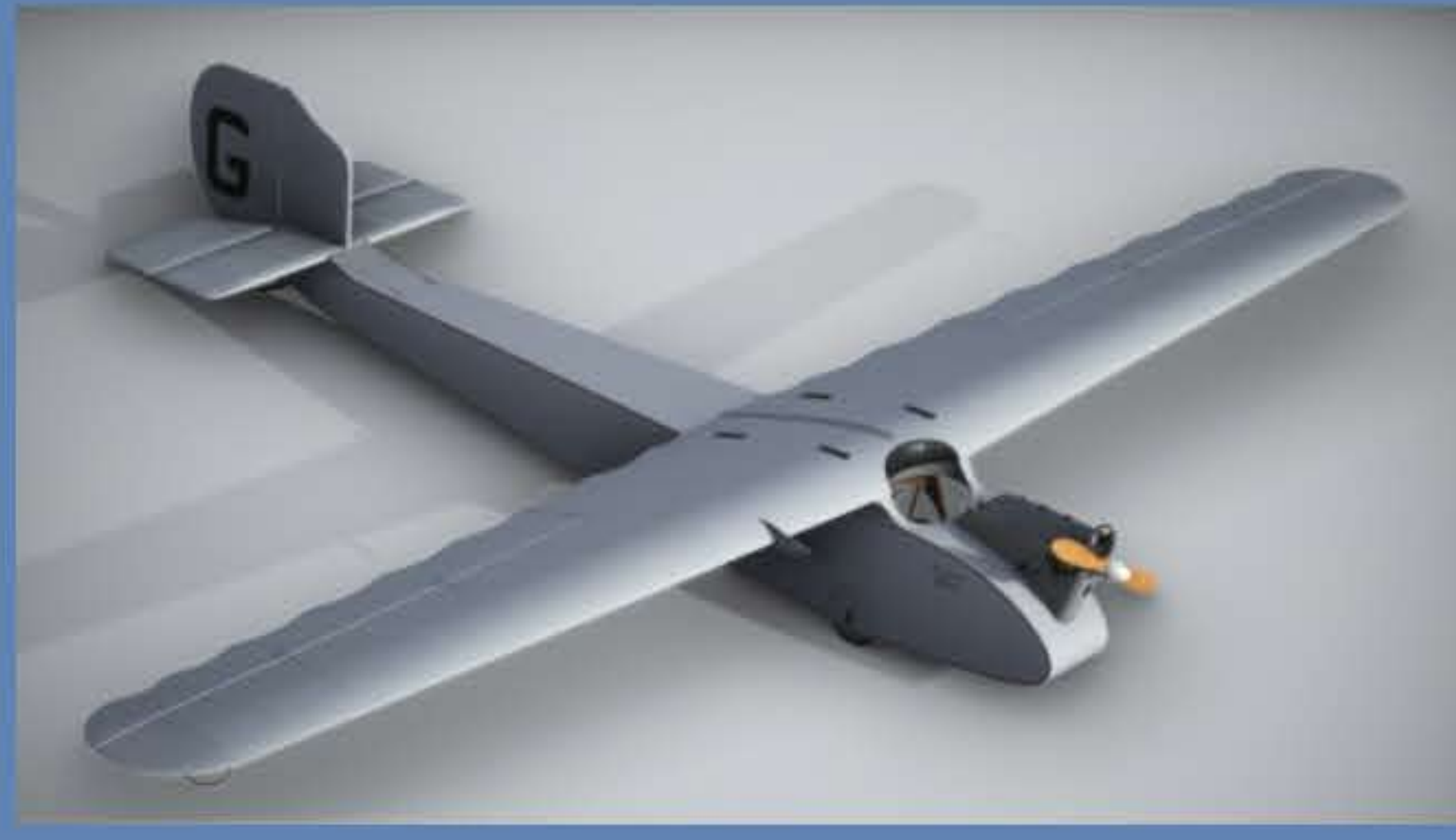





# *RARA-AVIS SIMS*

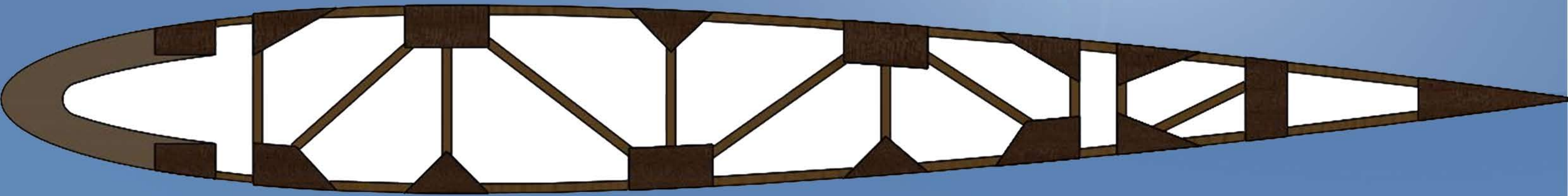

## Credits

Craig Richardson

3D modelling  
Textures  
XML Gauges  
Flight Dynamics

Iconic from the Noun Project

Eagle Clipart

For further support, please contact [rara-avis\\_sim@outlook.com](mailto:rara-avis_sim@outlook.com)

Craig Richardson  
© 2023 by Rara-Avis Sims.